

# Reconnecting with the Otta River

Situated in Bismo, Skjåk kommune, the project reestablishes a vital connection between the town and the Otta River, ingeniously building upon a proposed flood wall that aims to protect the community from recurring floods. The project transcends the typical defensive approach by integrating interactive public spaces into the flood wall design. This fusion of architecture and landscape spawns amenities such as bird-watching towers, fishing platforms, a natural beach bay, a public sauna, and an overnight cabin. Careful site selection intertwines existing infrastructure and community-selected sites, allowing people to experience the river intimately rather than simply traversing its edge. By maximizing the breathtaking mountain views, the project promotes a deep appreciation of Bismo's scenic charm and increases the town's undoubted natural attractiveness for locals and visitors.

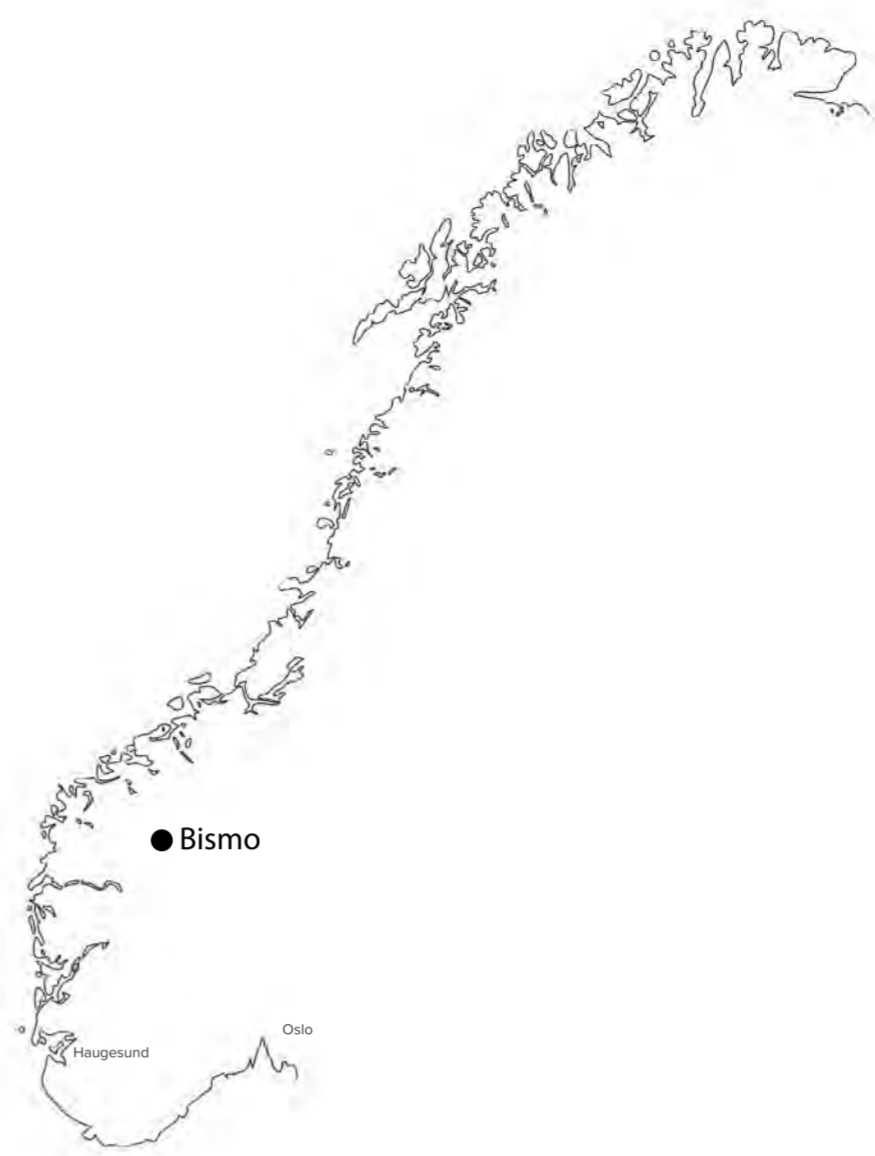

## Short about ongoing Bismo flood wall project

This project addresses the construction of a flood wall in Bismo, carefully designed to minimize disturbance to the existing nature trail and edge vegetation. The flood walls, characterized by relatively low height, will be homogeneous earth dams built using soil types with low permeability. The top sections of the walls, 3.0m wide, will serve as walkways. Erosion protection with armor stones is required on specific wall stretches, specifically in the Western, Middle, and Eastern sections. Existing temporary flood walls constructed post the 2018 flood will serve as building materials for the new construction. The flood wall will run along Skjåkvegen and the industrial area in the western parcel, the Industrivegen and Skamsarvegen area in the middle parcel, and the Blåbærmyra in the eastern parcel. Geological examinations carried out in fall 2020 revealed the presence of predominantly gravel and sandy soil. Locally sourced surplus materials unsuitable for the construction will be disposed of, and the municipality will assist in finding suitable sites for their deposition. A safe construction execution plan must be developed prior to the commencement of work. Environmental adaptations such as minimal removal of edge vegetation and including local vegetation cover on the flood wall have been considered. The project also includes post-construction clean-up work, reinstatement of edge vegetation, and returning temporary use areas to their natural state. The construction poses some inherent risks, such as overtopping or potential failure of the flood wall during extreme events.



Leading strategies to design an engaging public space for local interaction

the path	location	accessability	small footprint	identity	activate the site
To improve connectivity in Bismo, it is proposed to create an accessible walkway along the river, and incorporate designated crossings at specific points. This will facilitate a smoother flow and enhance accessibility throughout the area.	To ensure optimal placement of new activities in Bismo, it is advisable to consider the existing infrastructure. Public spaces can be strategically situated at intersections of main axes or roads, taking advantage of the available amenities.	Design elements such as stairs and ramps should be incorporated to ensure easy access for everyone to public spaces.	Minimize the impact on the site to leave the surroundings in its natural shape by using small interventions.	The proposed spaces and the path should have the same architectural expression to create a landmark that Bismo can identify with to be a part of the community.	The functions chosen along the nodes help to activate the site during different hours during the day and different seasons to create a lively and safe area.

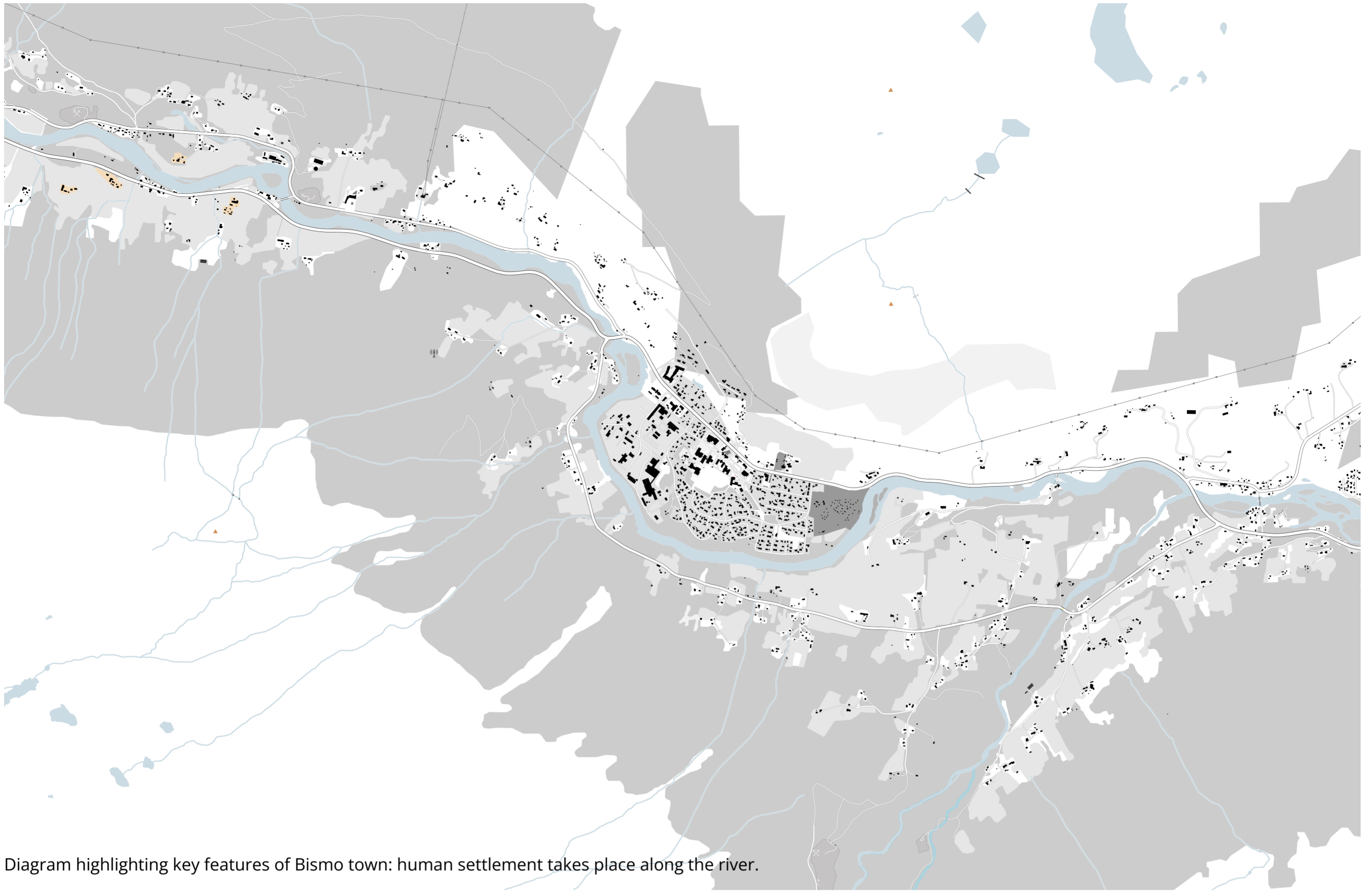
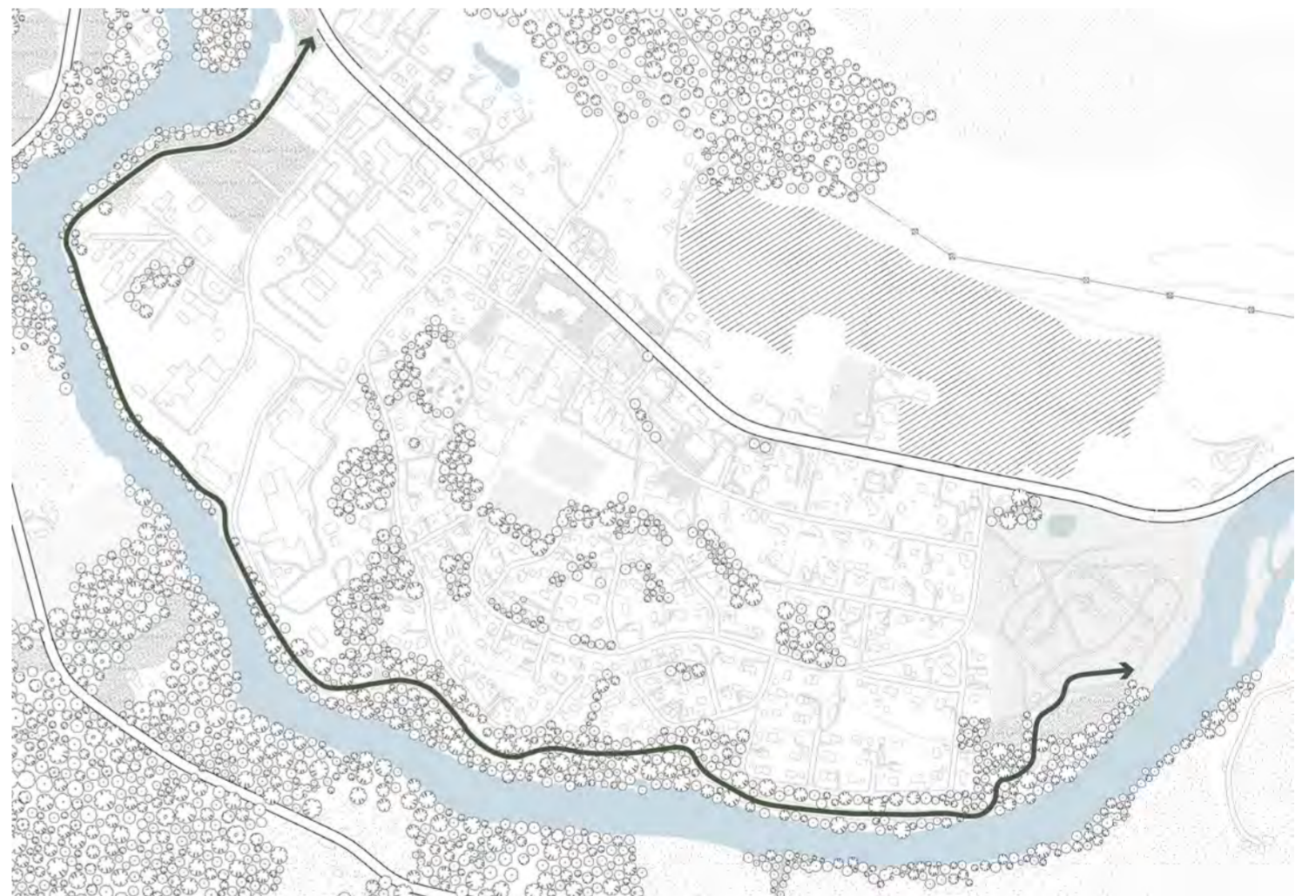

Diagram highlighting key features of Bismo town: human settlement takes place along the river.



Proposed flood walls



Establishing a linear flow on top of the flood walls and existing paths

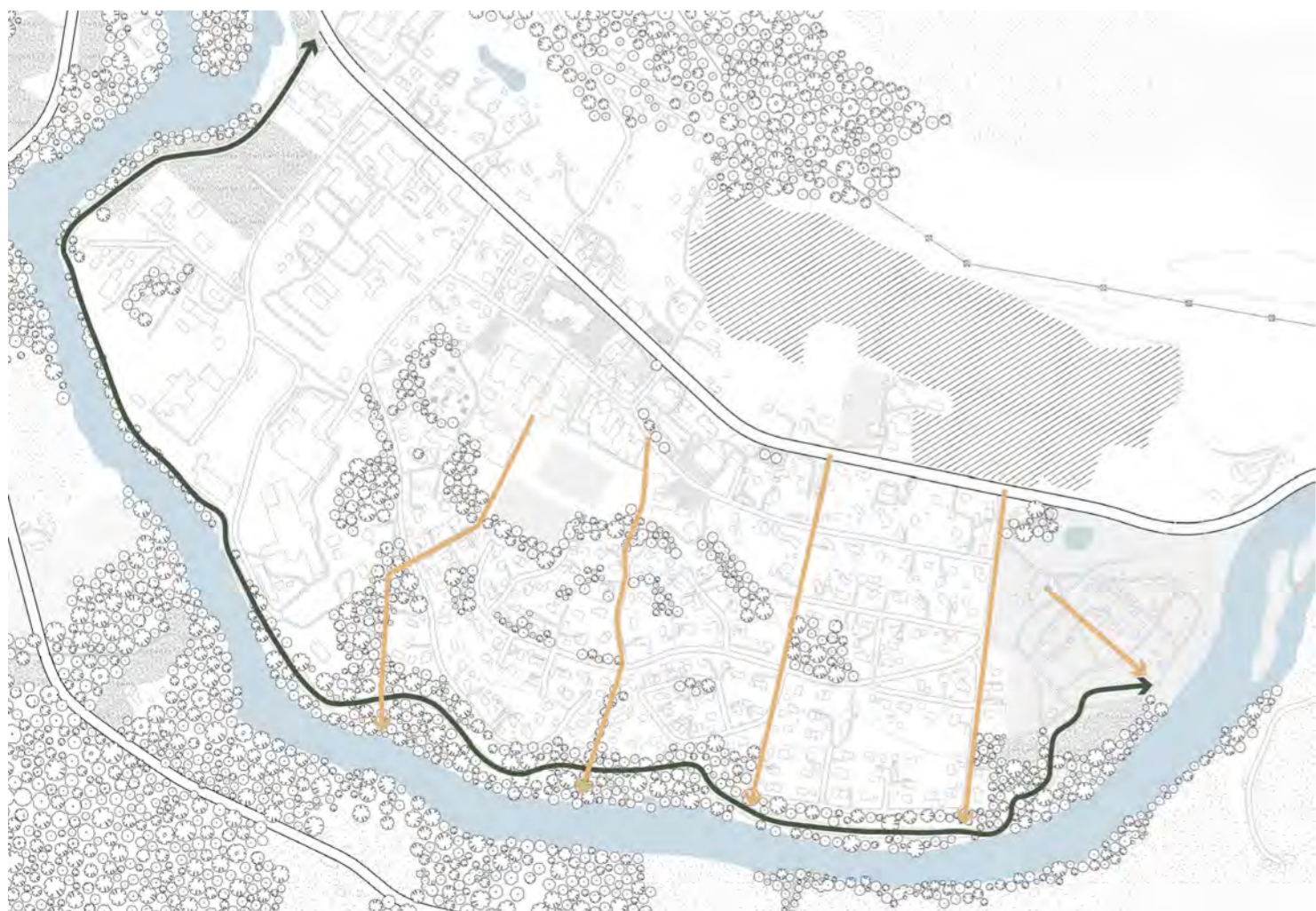

Looking for intersections where the path and existing infrastructure can meet



Proposed placement of new designs based on feedback from workshop and analysis

# The Riverside Viewpoint tower

Climb to new heights of discovery at the Bismos Viewpoint Tower. Situated by the river, this multi-story structure offers panoramic views of the stunning Bismo landscape. Crafted from locally-sourced timber and steel elements, the tower blends seamlessly into the natural surroundings. Its accessible design invites all nature enthusiasts to enjoy the sweeping panoramas from the observation deck, equipped with informational posters about local bird species and hilltops.

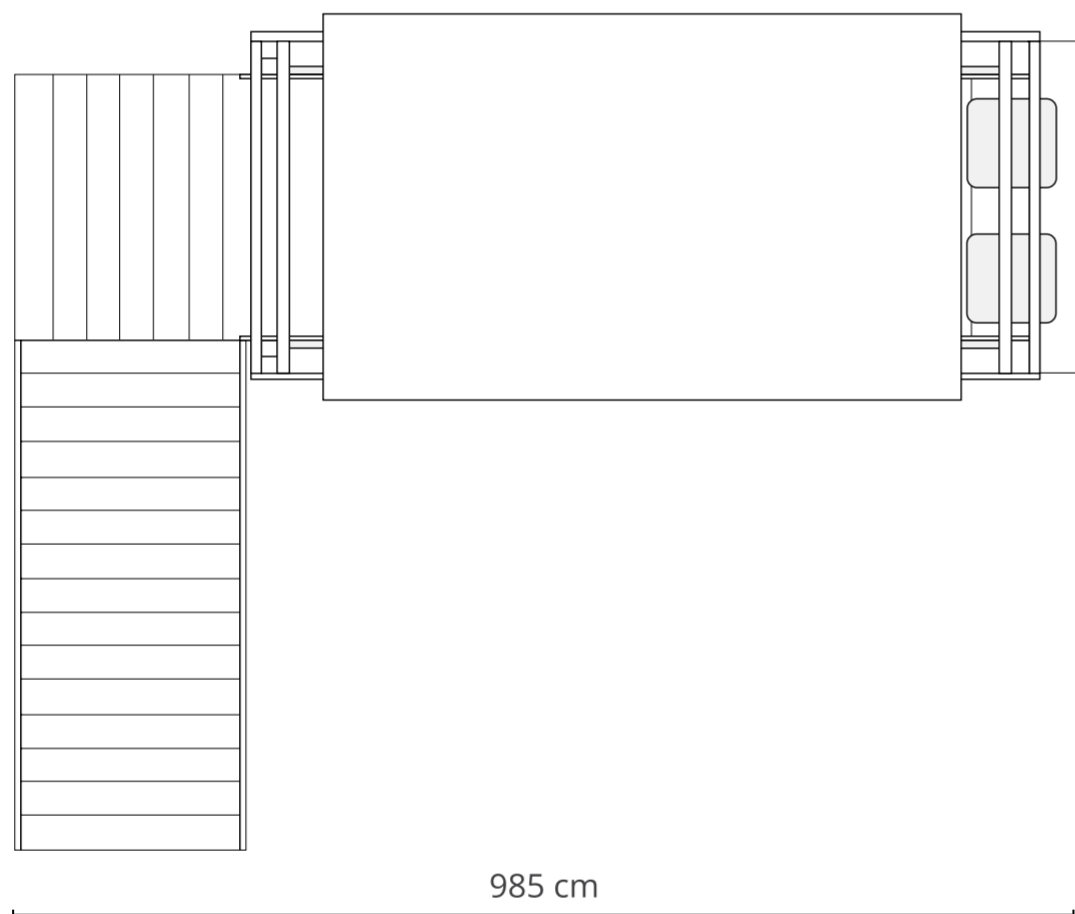
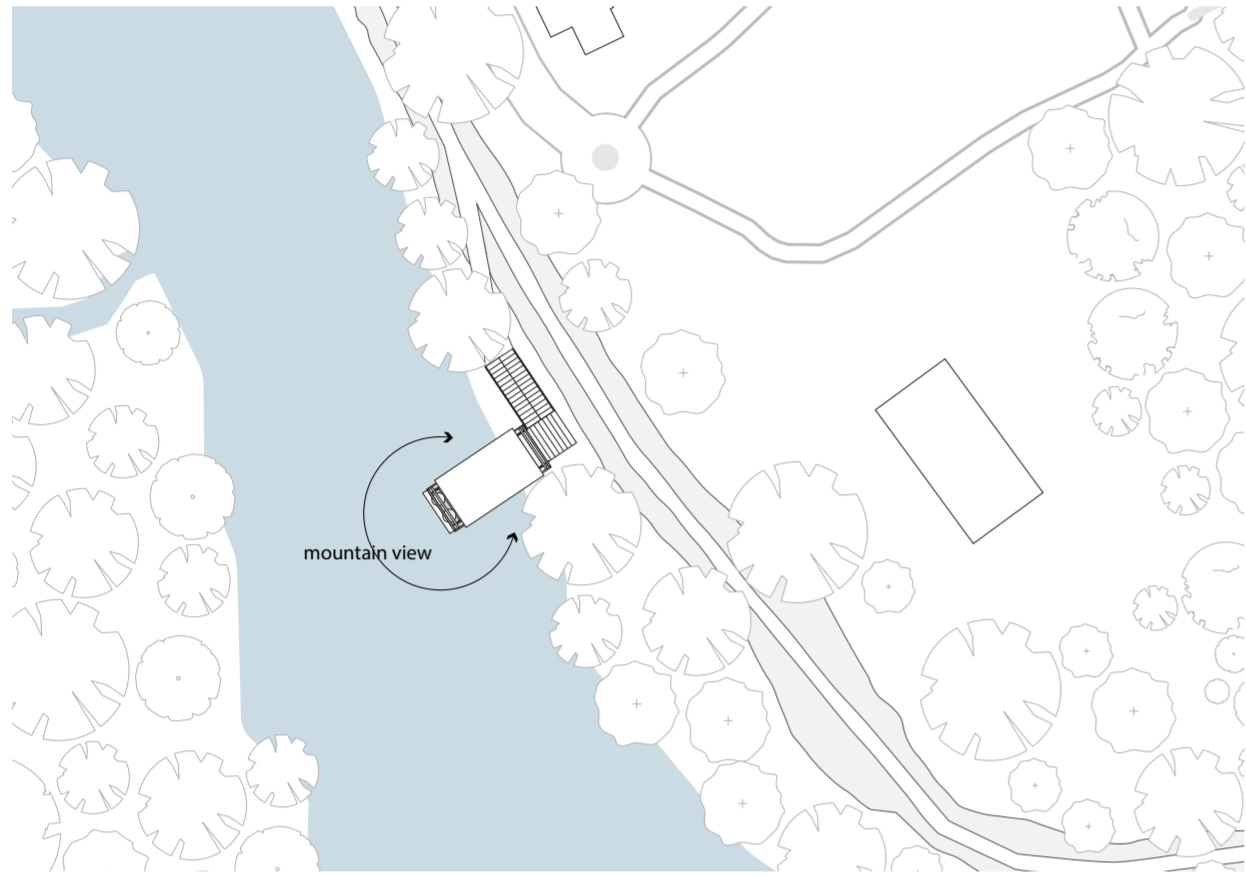

The viewpoint tower. Roof view.

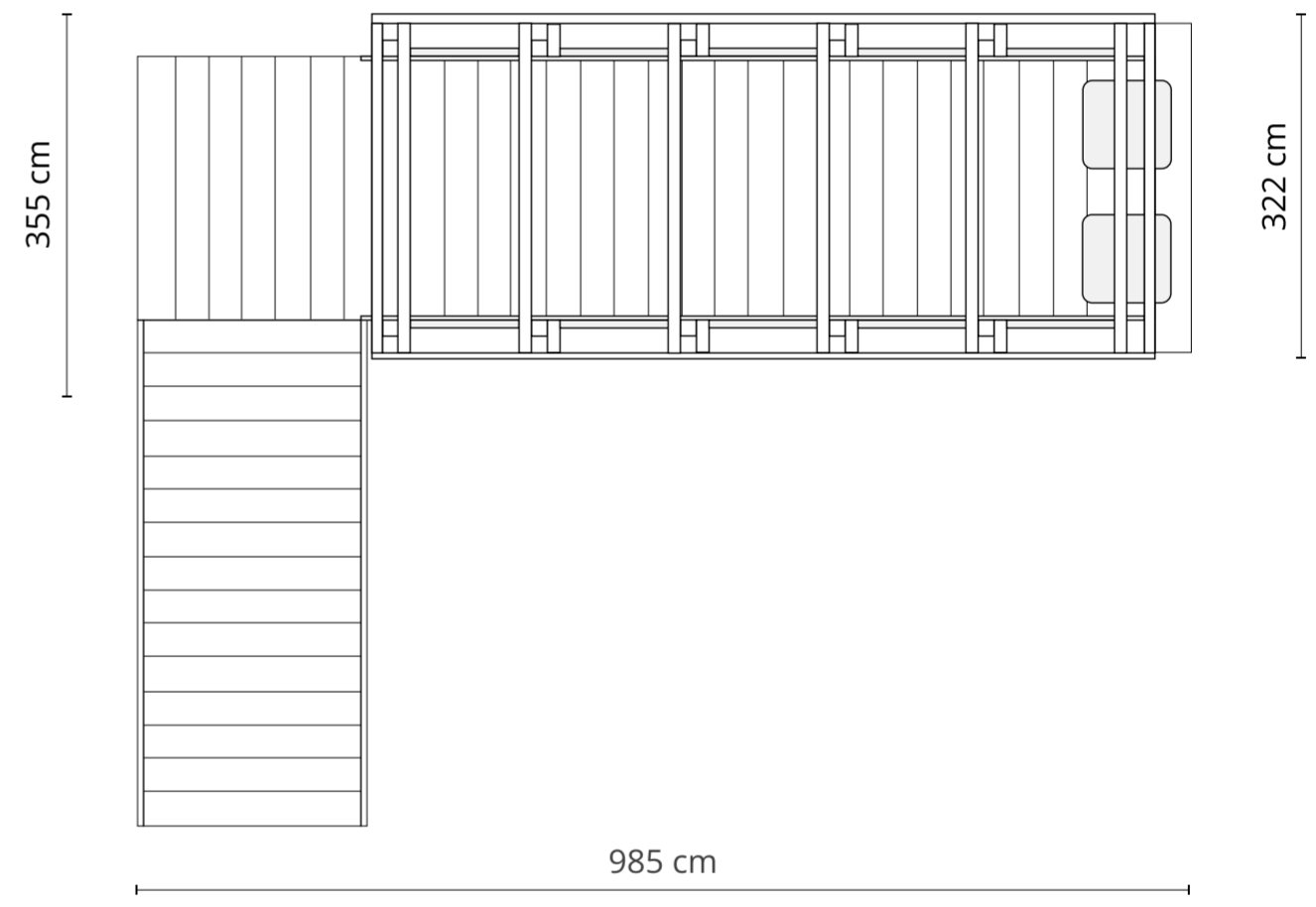

The viewpoint tower. Plan view.

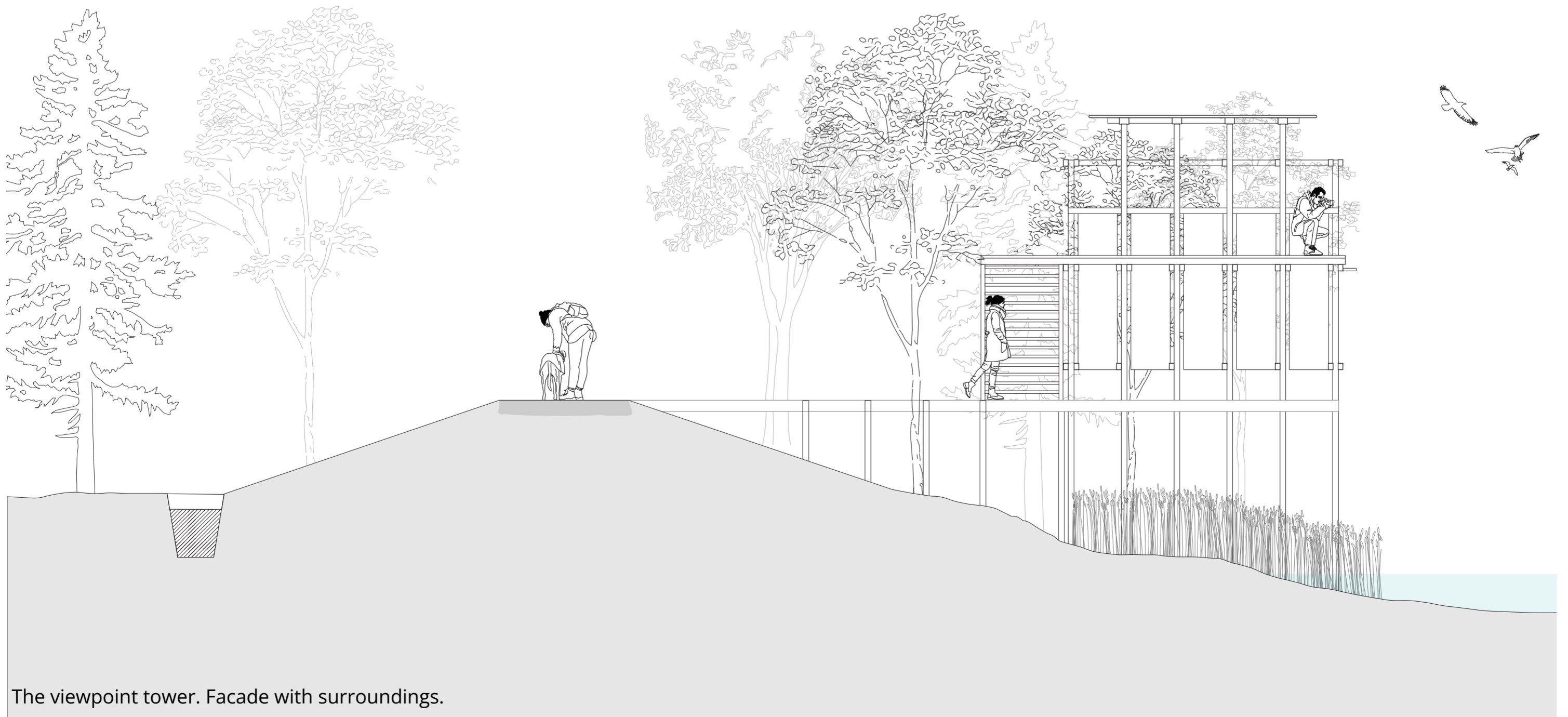

The viewpoint tower. Facade with surroundings.

# The Riverside Fishing Platform

Welcome to the Bismo's fishing platform, a celebration of outdoor recreation and community connection. Situated on a rivers surface, this floating structure offers a dedicated space for fishing, kayaking, and water sports. Crafted from durable, locally-sourced timber, it offers a peaceful retreat for fisherman and a dynamic water sports zone for thrill-seekers. The fishing platform ensures an inclusive, engaging, and fun-filled riverside experience.

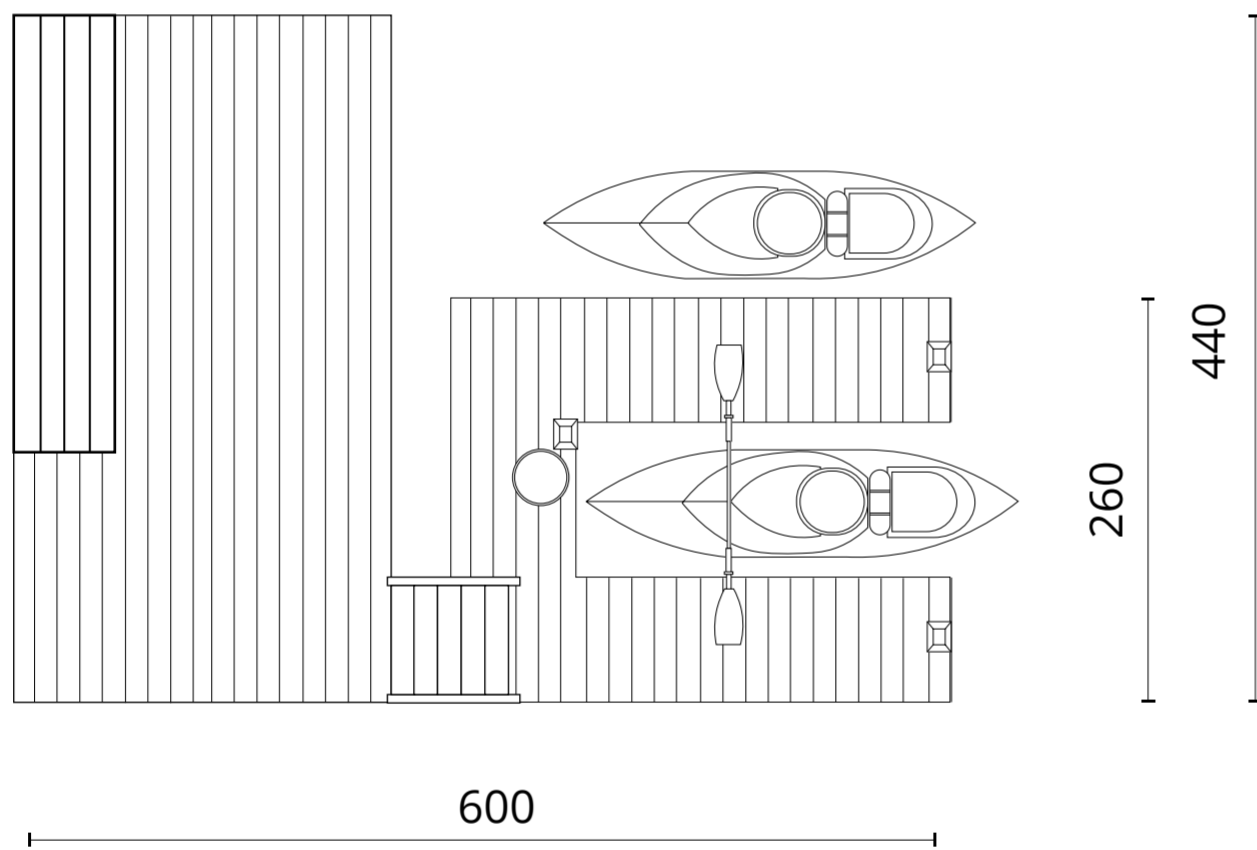
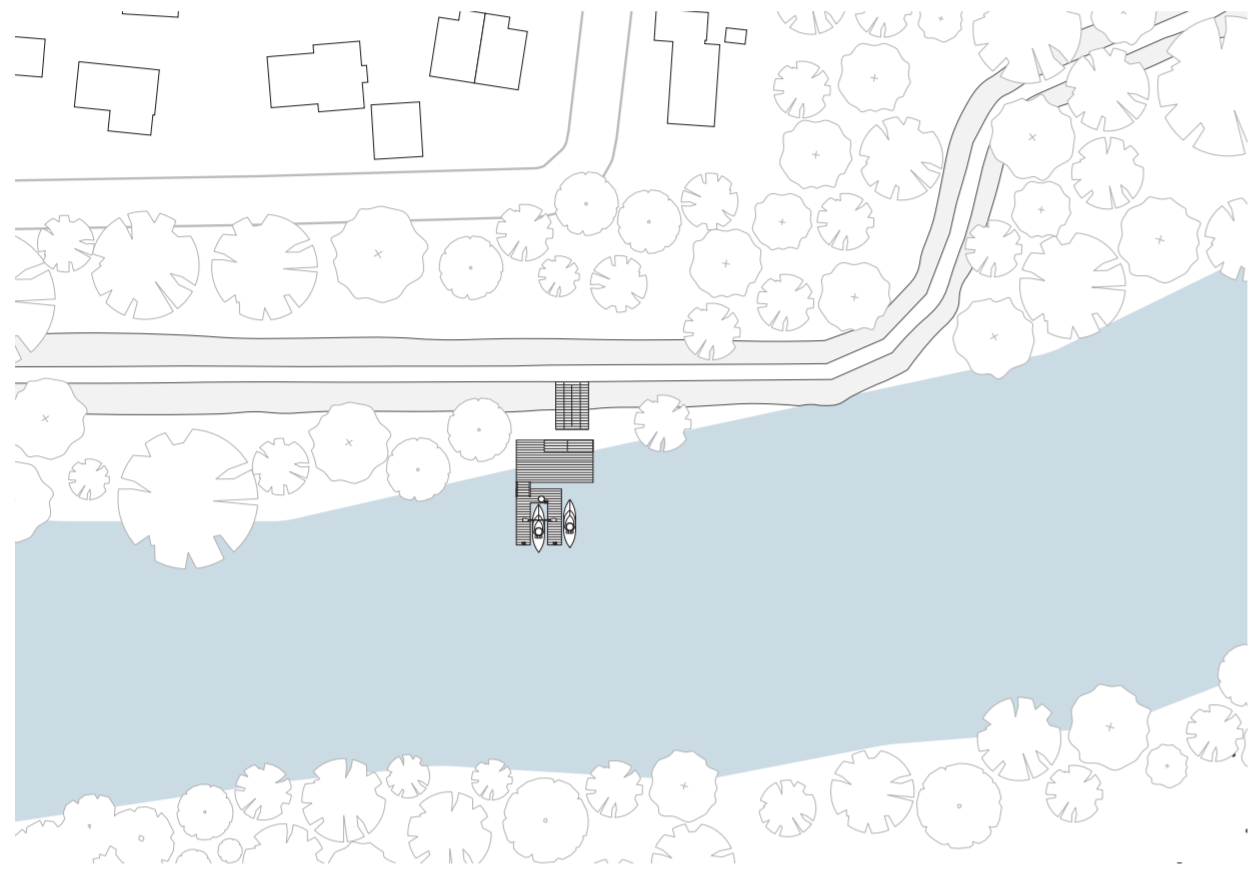

The fishing platform. Top view.

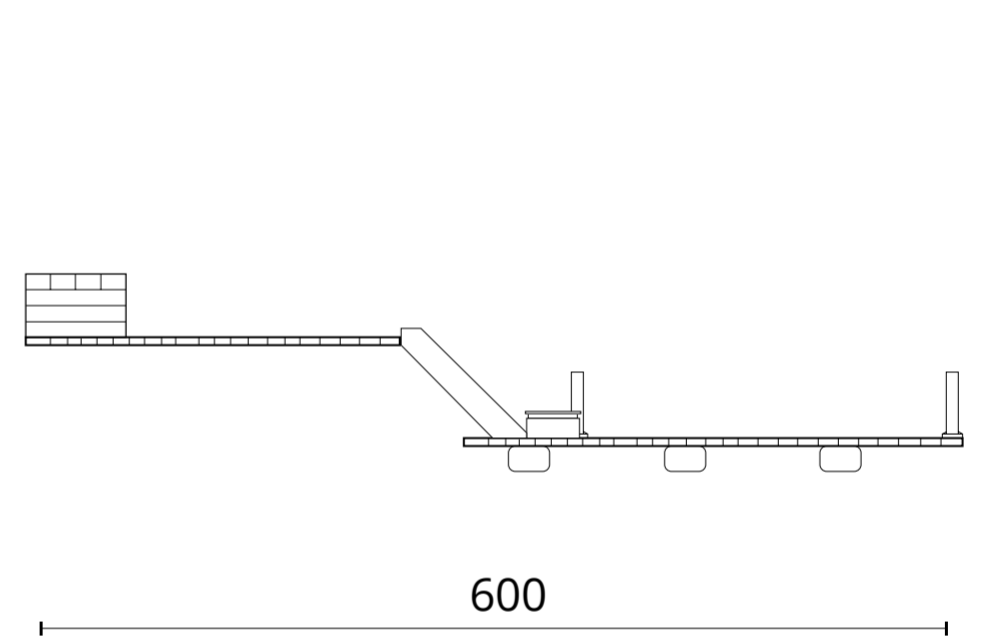

The fishing platform. Section.

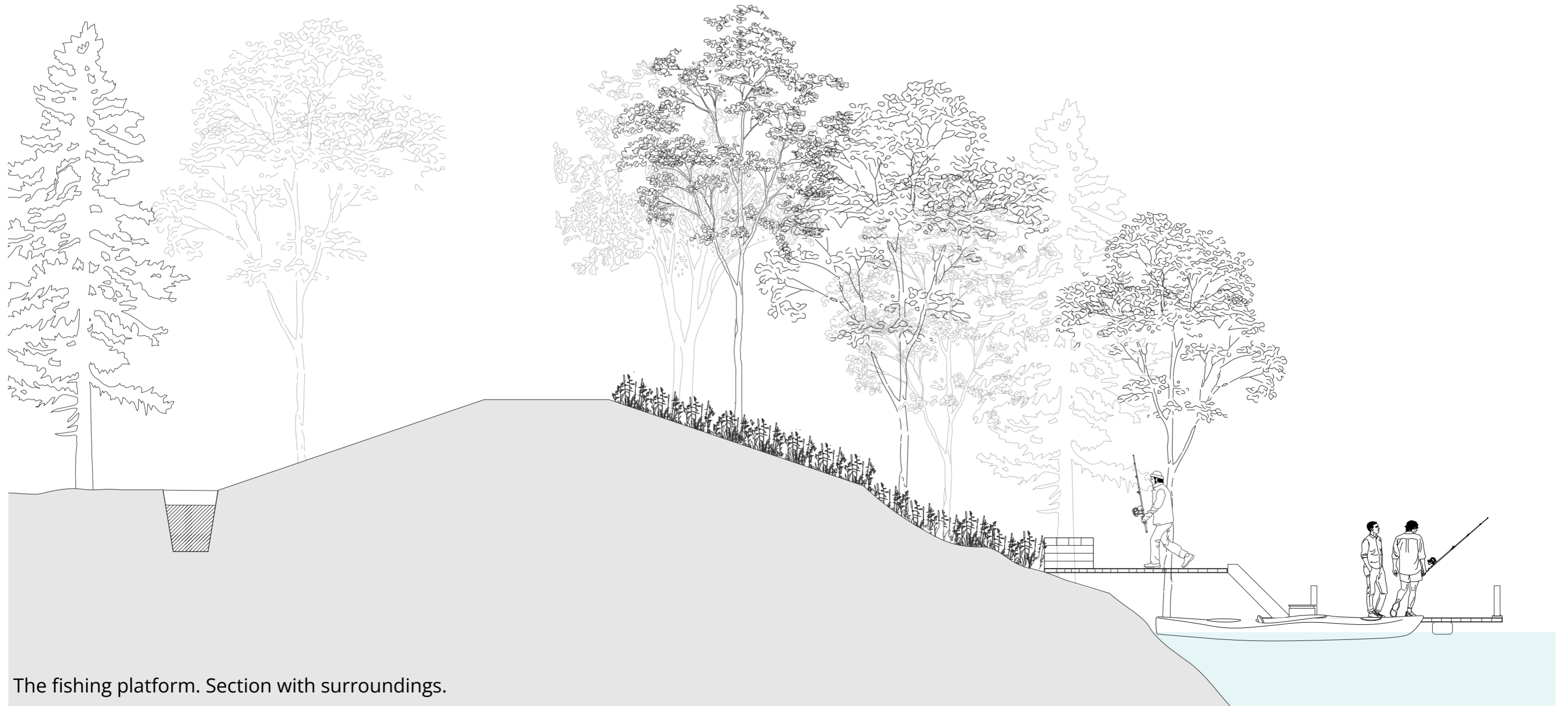

The fishing platform. Section with surroundings.

# The Riverside Cabin

Immerse yourself in Norway's 'friluftsliv' ethos at the secluded Bismo cabin. Echoing elements from the indigenous 'gapahuk', this overnight retreat nestles along the Otta riverbank, ensconced by the majestic mountain landscape. The cabin embodies a symphony of coziness, practicality, and unfiltered natural immersion, devised to amplify your bond with the wilderness. Shaped with regionally procured timber and glass, its architectural blueprint integrates modern conveniences within its streamlined aesthetics. Its unique features include a dedicated barbecue zone and a deck adjacent to the river

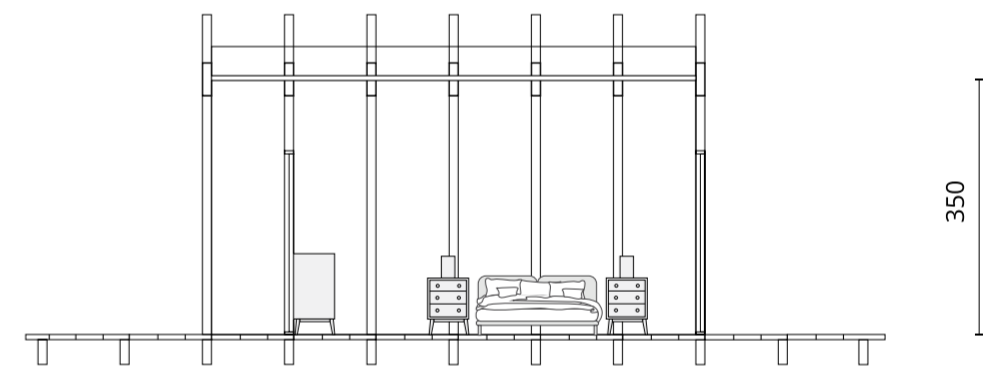
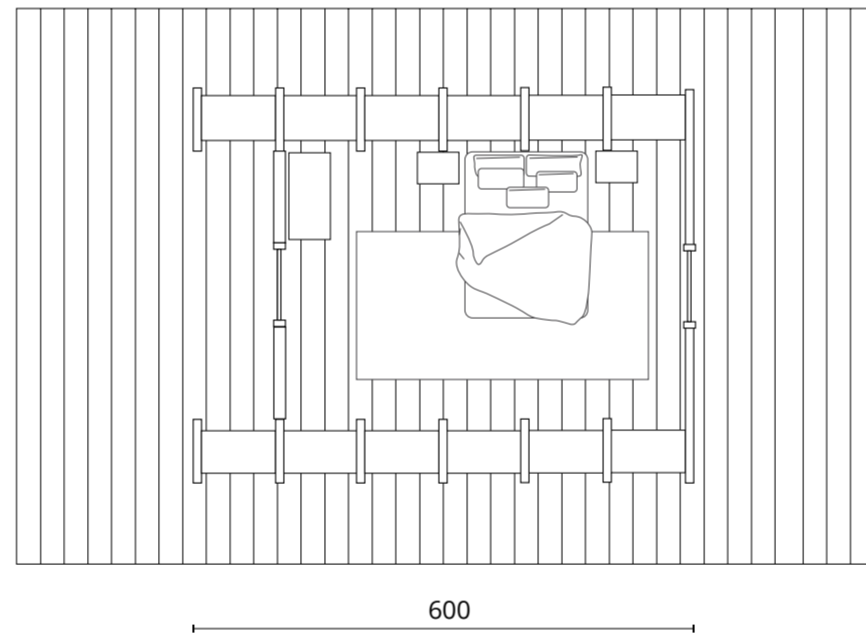
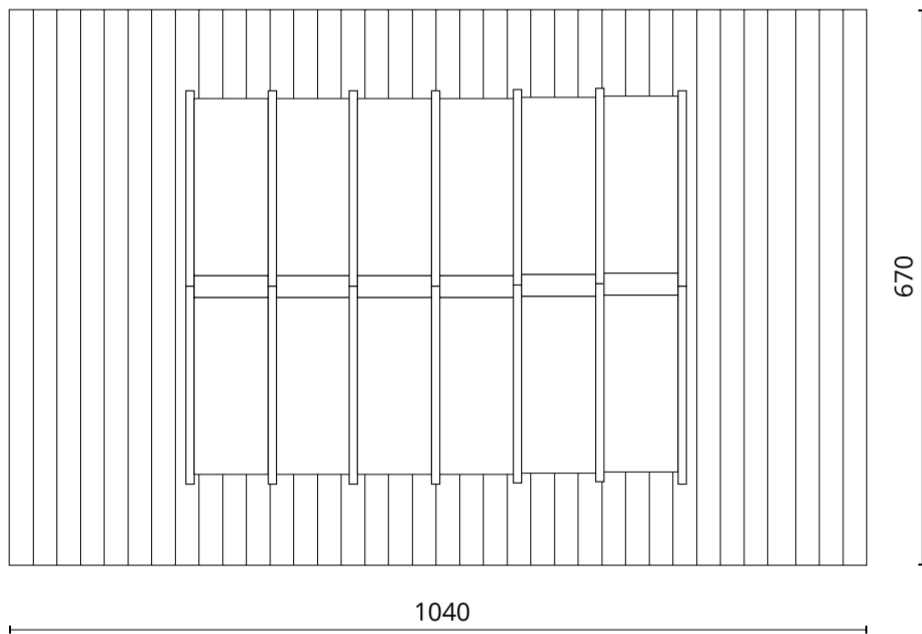
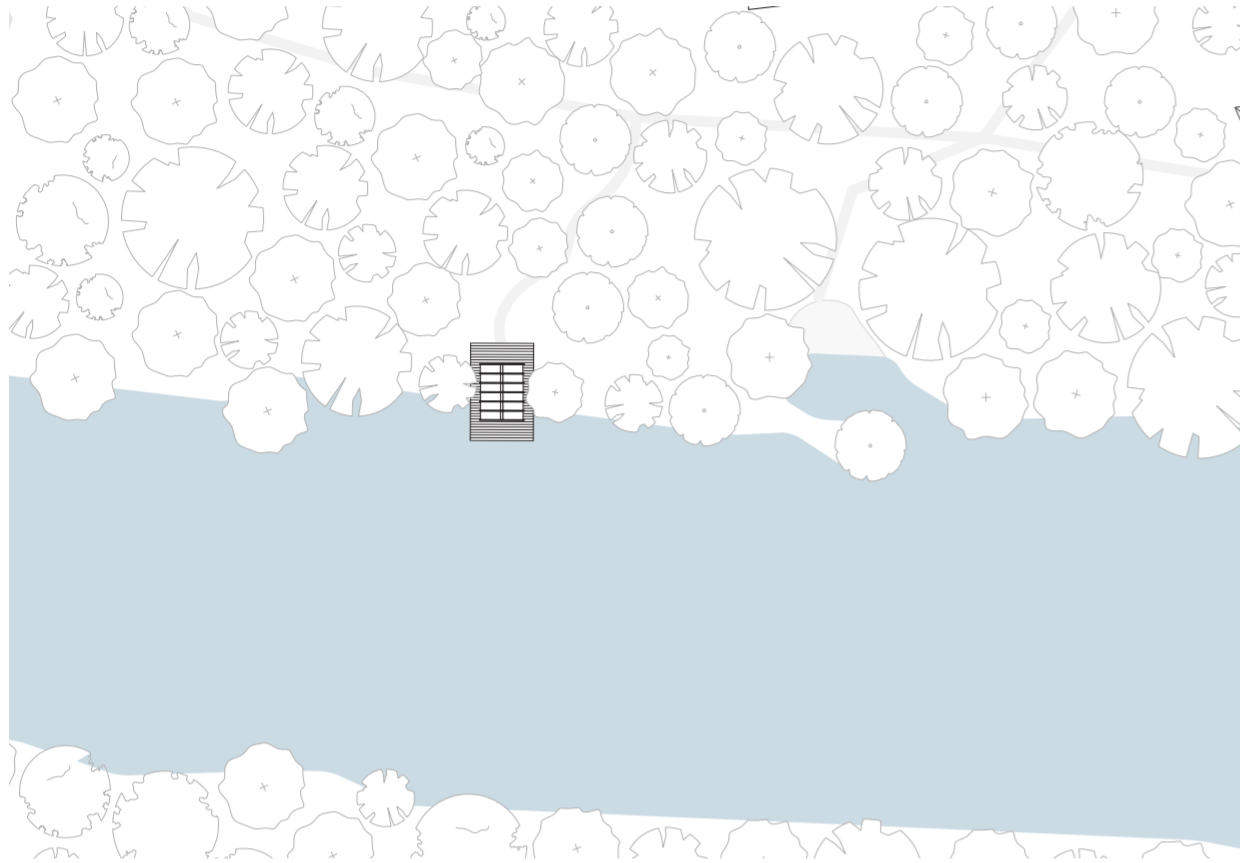

The cabin. Roof view.

The cabin. Plan view.

The cabin. Section.



The cabin. Section with facade and surroundings.

# The Riverside Sauna

Immerse yourself in the warmth of Norwegian tradition at the Bismo's Riverside Sauna. This communal wellness space, floating on the banks of the Otta River, combines the joys of sauna culture with the breathtaking beauty of nature. Crafted from locally-sourced timber, the sauna offers a 'koselig' retreat, with tiered benches, showering spaces, and panoramic river views through expansive glass windows. More than just a sauna, it is a hub for community connection, relaxation, and regeneration. Experience the therapeutic power of heat, water, and cold water.

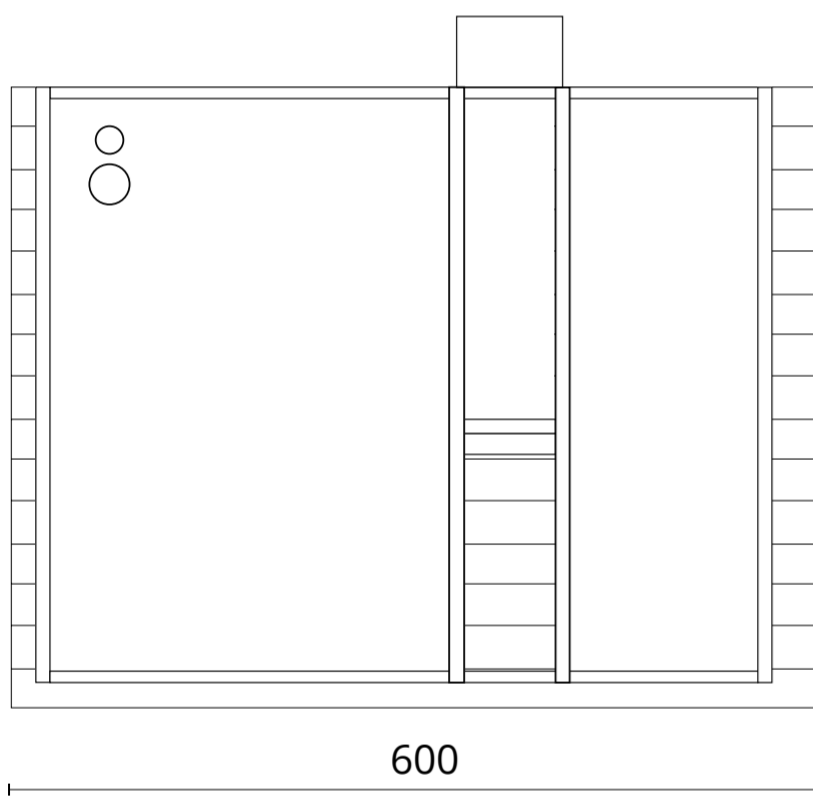
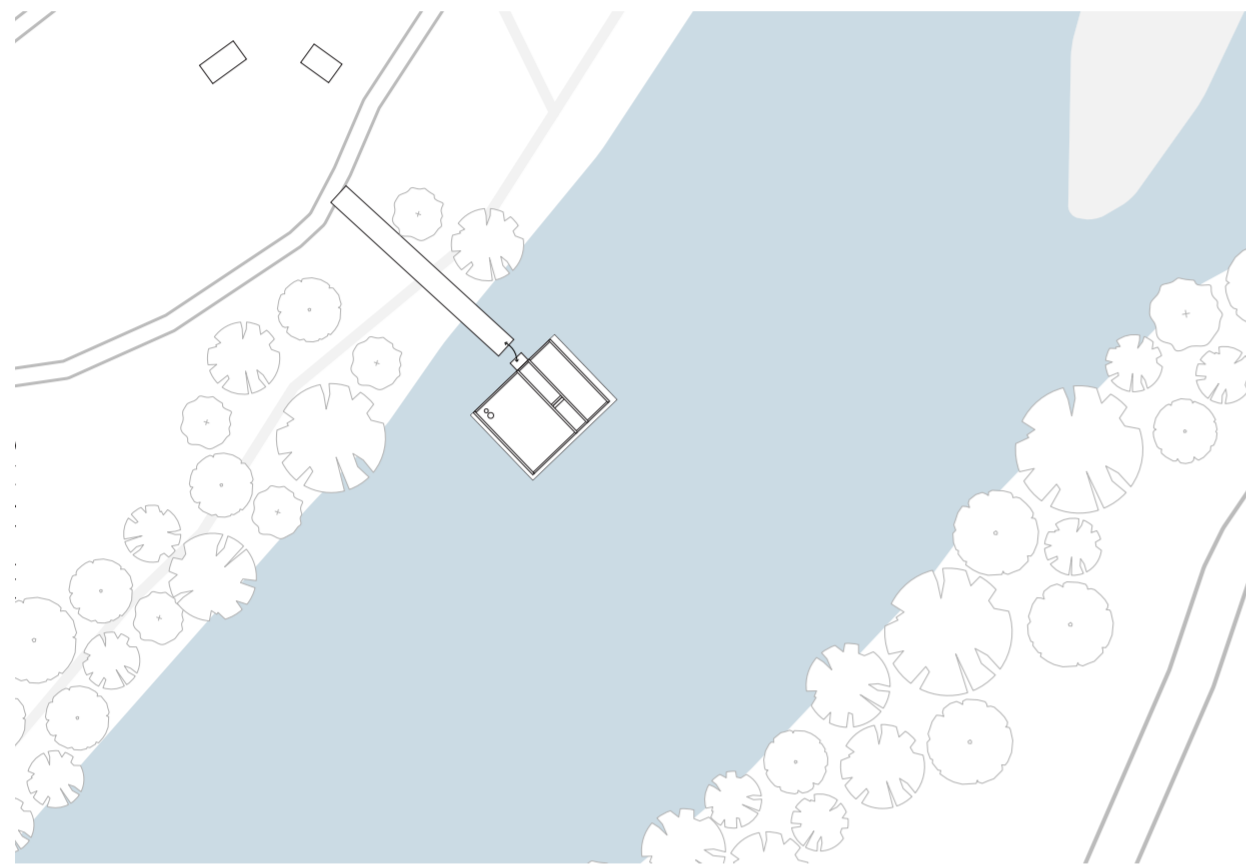

The sauna. Roof view.

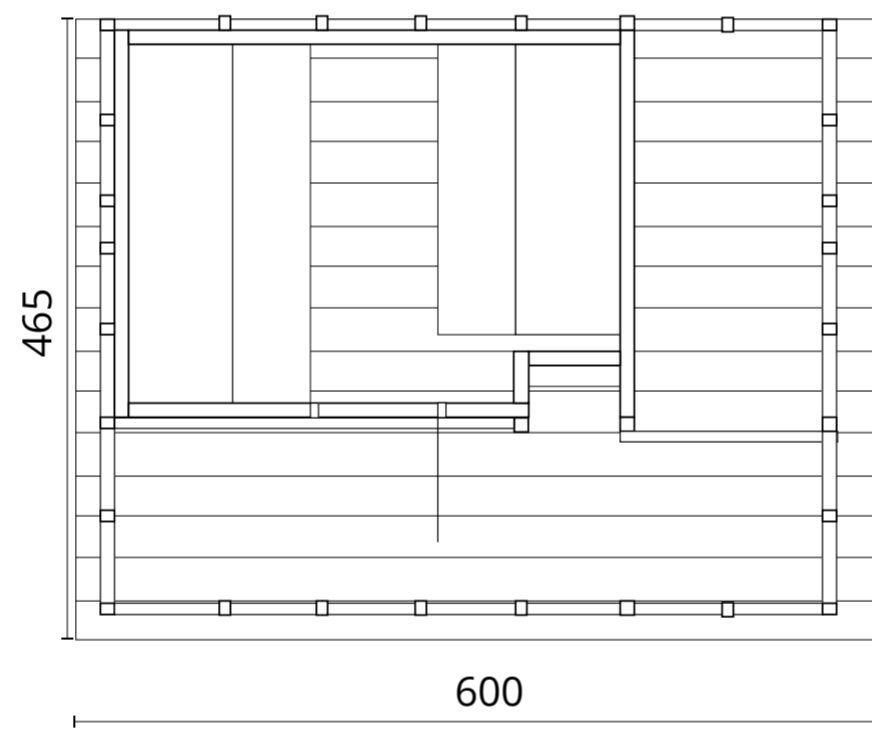

The sauna. Plan view.

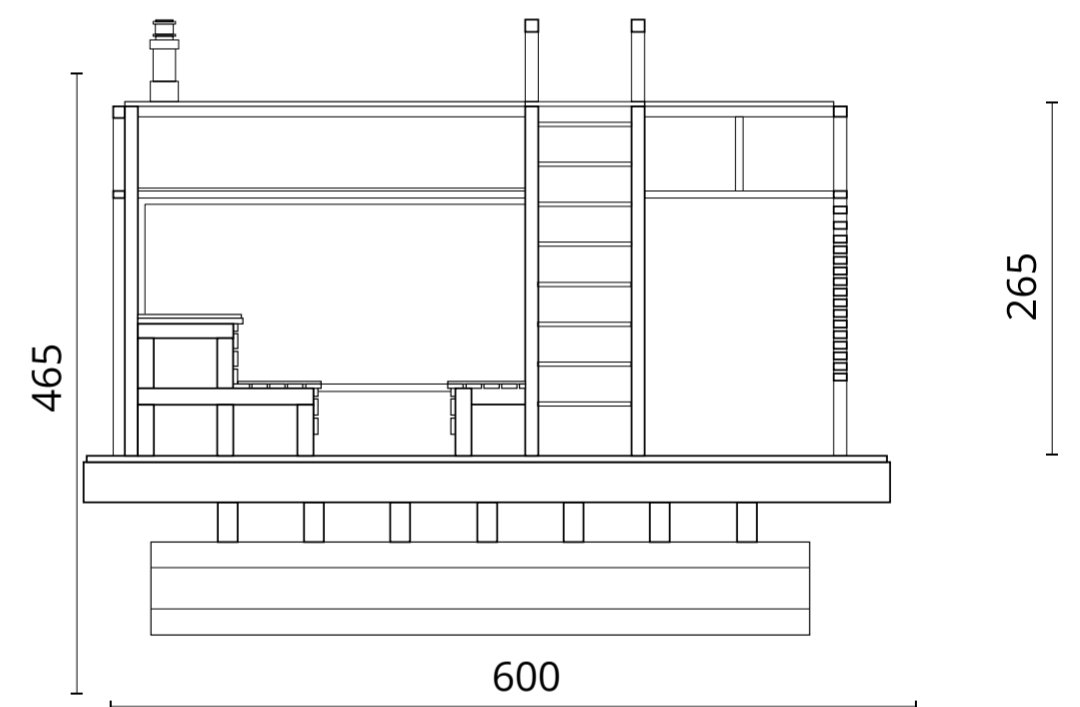

The sauna. Section

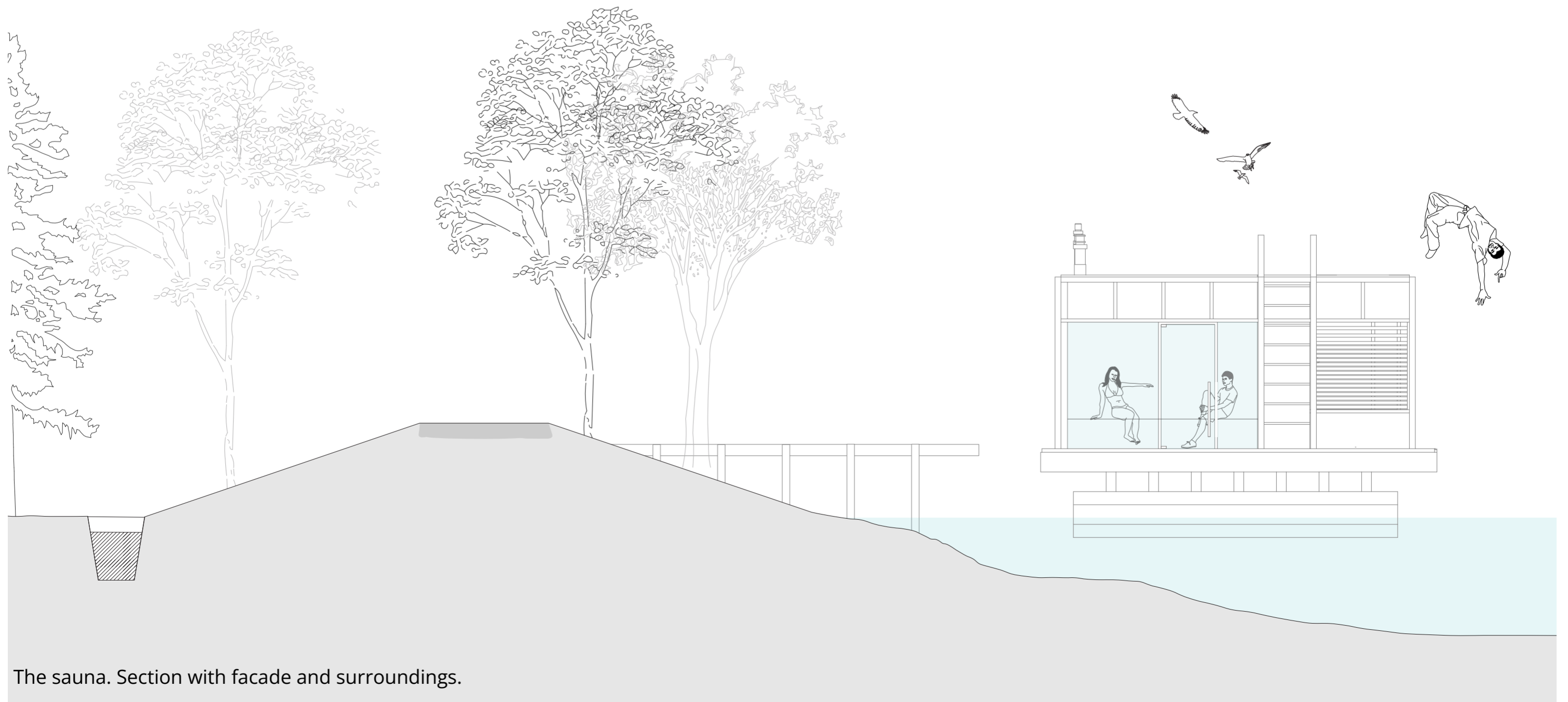

The sauna. Section with facade and surroundings.

# The Bismo Beach

Discover a haven of relaxation and playful exploration at Bismo's beach. This reimagined coast on the Otta Riverbanks pairs natural beauty of already existing beach with thoughtful design, providing a child-friendly space for leisure and safe water access. The gentle, sloping beach leads to a designated shallow swimming area secured by natural boulders. Interactive play zones, natural climbing structures, and serene seating areas punctuate the landscape, inviting children and families to connect with nature.

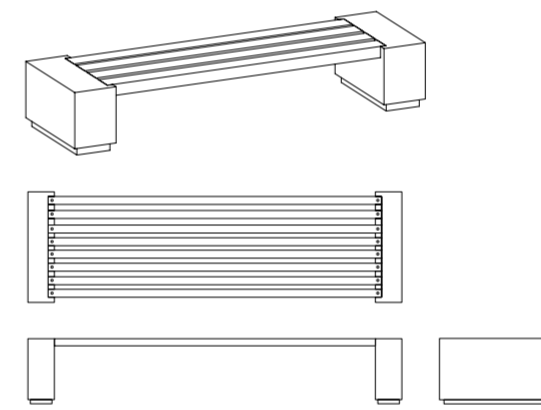

Incorporating natural materials during the design of a small sand beach for a local community emphasizes environmental sustainability and enhances the innate charm of the space. Using locally-sourced sand, stones, and native plants reduces environmental impact and creates a space that harmonizes with the local ecosystem, thus fostering a greater sense of community connection and stewardship.

Implementing small-scale architectural features is an effective strategy to promote beachside congregation and encourage the local community to embrace the beach as a social hub. Introducing amenities such as benches, fire pits, and shaded structures can create inviting spaces that attract individuals and families, offering comfortable leisure, socialization, and recreational activities. These additions are aesthetically pleasing and functional, adding value to the beach experience and fostering a sense of community in the process.



The beach. Section with surroundings.